



Mi • Light Subordinate New Brand

Smart Panel Controller

II . Introduction

Smart Panel Controller is a newly high-end controller. The appearance is made of a pretty and fashionable glass panels. And we adopt a high precision Capacitive touch screen IC. Touch Screen is very stable. Also It has memory function (Turn off the light, then turn on again, The lamps will keep the same light as before). This controller widely work on Single Color, CCT, RGB, RGBW and RGB+CCT LED strip. Also work on Flexible strip, Panel light, Rolling strip. Easily install and operate.

III . Technical Parameters

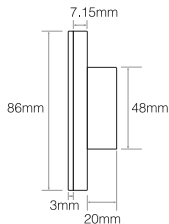

Model No.	P3	
Working Temperature	-20~60°C	
Working Voltage	DC12V~24V	
Output Max	5A/Channel	
Total Output Max	10A	
Output Connection	Common anode	
Panel Size	L86*W86mm	
Packing Size	111*111*38mm	
Net weight	122g	
Gross weight	177g	

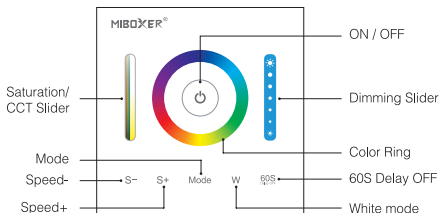

P3 RGB / RGBW / RGB+CCT Panel

P3 Function

This controller is compatible with RGB,RGBW and RGB+CCT version. It will be RGBW Version when you get it first time.

I . Method of Switching RGB,RGBW and RGB+CCT version

1. When the Light is OFF, Long press **"Mode"** and **"W"** button at the same time,The controller will sound 3 times after 5seconds,then it change to RGB version.
2. When the Light is OFF, Long press **"W"** and **"60S"** button at the same time,The controller will sound 4 times after 5seconds,then it change to RGBW version.
3. When the Light is OFF, Long press **"Mode"** and **"60S"** button at the same time,The controller will sound 5 times after 5seconds,then it change to RGB+CCT version.

II . Button Function



ON / OFF Switching. When the light is ON, Indicating lamp will not light, when the light is OFF, Indicating lamp will light.

W

Press “W”, Switch to Static White Light mode.

60S

Delay OFF

1. When the light is ON, press “ **60S** ”, the light will be off Automatically after 60 seconds.
2. When light is OFF, Long press 5 seconds to turn ON the indicating sound.

Color Ring

Touch Color Ring, Choose the color you want.

Dimming Slider

Touch Dimming Slider to change the brightness from 0.1~100%.

Saturation/CCT Slider

Each modes have their own brightness value and saturation value(Static white light mode and dynamic white light gradual changing mode have no saturation)Function see details for P3 sheet.

Mode

1. Press “**Mode**” shortly, Switch to next mode; Long press “Mode”, Switch the Modes circularly, there are 12 kind modes.(PS, on the color light, press Mode, it will get to first mode).
2. In the version of RGB+CCT, White gradual changing mode means CCT gradual changing under static white mode.
3. When light is OFF, Long press 5 seconds to turn OFF the indicating sound.

S-

Slow the speed on present dynamic mode. There is 9 class speed. Long press “**S-**”, Slow the speed continuously. When it get to slowest speed, S- will be invalid.(Dynamic mode see details for P3 mode sheet.)

S+

Accelerate the speed on present dynamic mode. There is 9 class speed. Long press “**S+**”, Accelerate the speed continuously. When it get to fastest speed, S+ will be invalid.(Dynamic mode see details for P3 mode sheet.)

V P3 Mode sheet

Model No.	State	Number	Mode	Adjustable Saturation / CCT Function	Adjustable Brightness (0.1%-100%)	Adjustable Speed		
P3	Static Mode	Color Ring	Color mode	Change Saturation	✓	✗		
		W Button	White light mode	<ul style="list-style-type: none">● Adjust CCT on RGB and RGB+CCT version● Adjust Brightness on RGBW Version				
		1	Red light mode	Change Saturation				
		2	Green light mode					
		3	Blue light mode					
		4	All colors gradual change					
	Dynamic Mode	5	White light gradual change			Adjust Brightness	✓	✓
		6	Red/green/blue color gradual change	Change Saturation				
		7	Seven color jump to change					
		8	Jump to change randomly					
		9	Red Gradual Change + Jump to change 3 times					
		10	Green Gradual Change + Jump to change 3 times					
		11	Blue Gradual Change + Jump to change 3 times					
		12	Demonstration mode (Dynamic mode change circularly)					

VI. Installation / Dismantlement

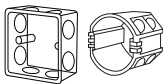

Install the bottom case into the wall;
Above are the standard bottom cases.

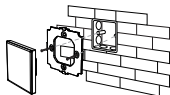

Fix the controller base on the bottom
case with screw.

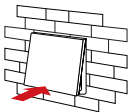

Clicks into the upper side of glass
panel on the controller base, then
press the lower side slightly to make
it clicks into the controller base.

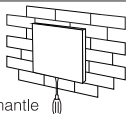

Dismantle

Plug into the below bayonet with a
screwdriver, and upwarp screwdriver,
then you can dismantle the controller.

Attention:

1. Please check whether the input voltage of the constant voltage power supply is in accordance with the controller, and please check the connection of both the cathode and anode.
2. The working Voltage is DC12-24V, the controller will be broken if the voltage is higher than 12-24V.
3. When Installation, pls handle with care to avoid the broken of the glass panel.



Made in China

